

RELIABILITY *for real life*®



STAIR LAYOUTS
GUIDE

Stair Layouts

JELD-WEN manufactures all staircases to order in almost any design, size or specification. However, to help plan your flight, our 20 most popular layouts are listed on the following pages together with the critical dimensions relevant to each design including the trimming dimension necessary to obtain headroom clearance. Our specialist stairs team is always on hand to offer help and advice on any aspect of design, construction or Part 'K' of the Building Regulations. You can contact them on 01664 484613 or speak to your dedicated stairs technician.



Layout A

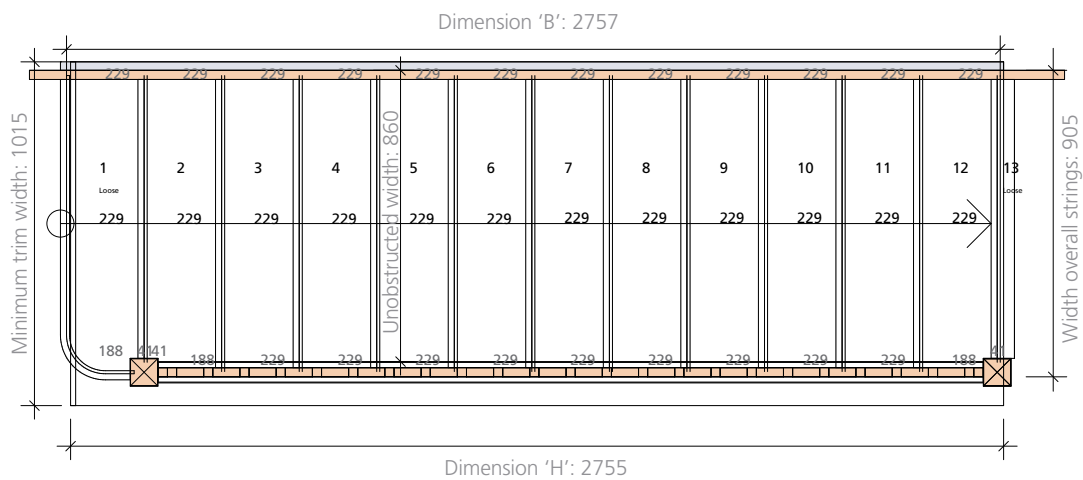

Dimensions

B: Face of bottom riser to back of top riser

H: Minimum distance to give statutory headroom
(Based on storey heights between 2588mm
up to 2680mm with 339mm floor zone)

Headroom based on storey heights between 2588mm
up to 2680mm with 339mm floor zone.

Unobstructed width dimension does not allow for a wall handrail;
should this be a requirement the projection of the handrail
need to be deducted.



Layout B

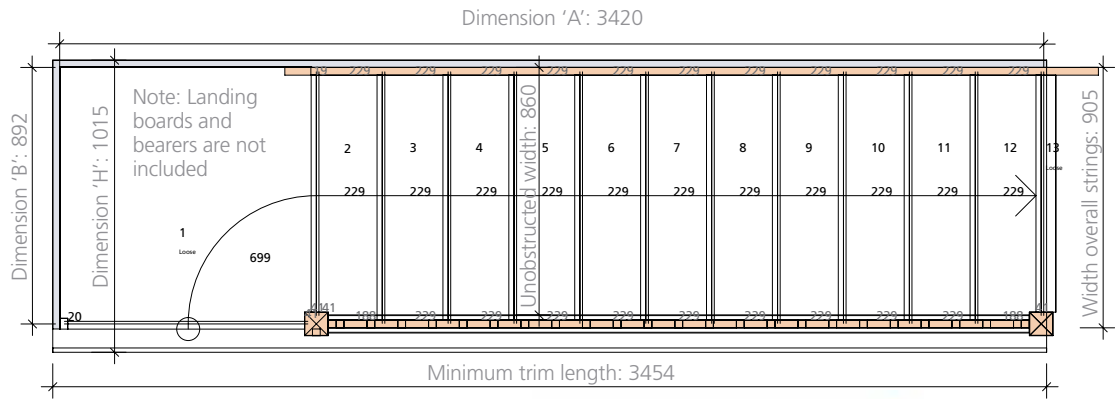

Dimensions

A: Wall string to back of top riser

B: Face of bottom riser to back of wall string

H: Minimum distance to give statutory headroom (Based on storey heights between 2588mm up to 2680mm with 339mm floor zone)

Headroom based on storey heights between 2588mm up to 2680mm with 339mm floor zone.

Unobstructed width dimension does not allow for a wall handrail; should this be a requirement the projection of the handrail would need to be deducted.



Layout C

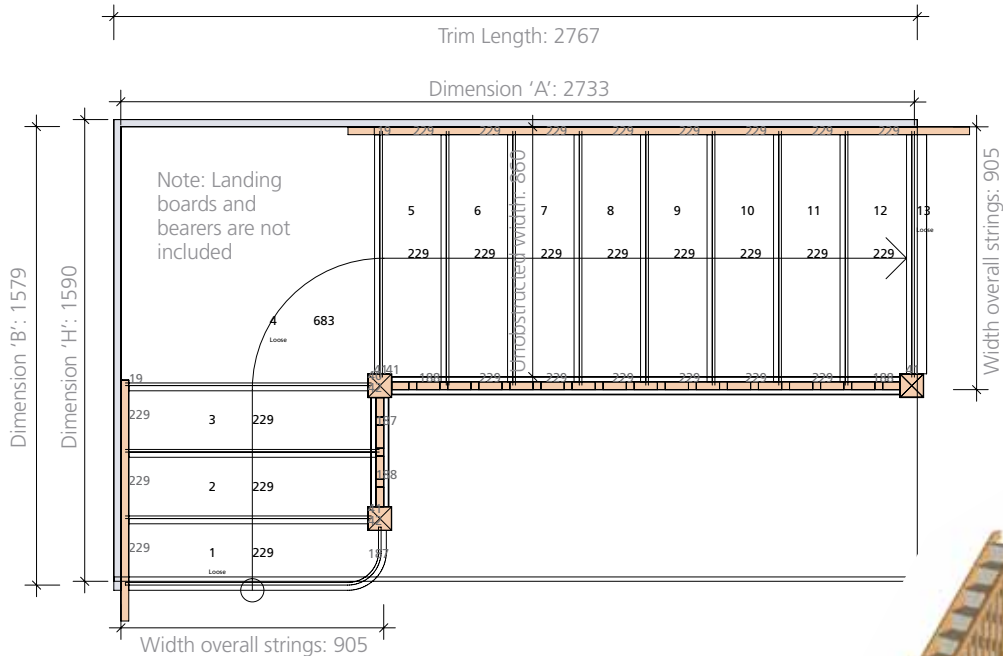

Dimensions

A: Wall string to back of top riser

B: Face of bottom riser to back of wall string

H: Minimum distance to give statutory headroom (Based on storey heights between 2588mm up to 2680mm with 339mm floor zone)

Headroom based on storey heights between 2588mm up to 2680mm with 339mm floor zone.

Unobstructed width dimension does not allow for a wall handrail; should this be a requirement the projection of the handrail would need to be deducted.



STAIR LAYOUTS

Layout D



Dimensions

- A: Wall string to wall string
 - B: Face of bottom riser to back of wall string
 - C: Back of top riser to wall string
 - H: Minimum distance to give statutory headroom
(Based on storey heights between 2588mm up to 2680mm with 339mm floor zone)
- Headroom based on storey heights between 2588mm up to 2680mm with 339mm floor zone.
- Unobstructed width dimension does not allow for a wall handrail; should this be a requirement the projection of the handrail would need to be deducted.

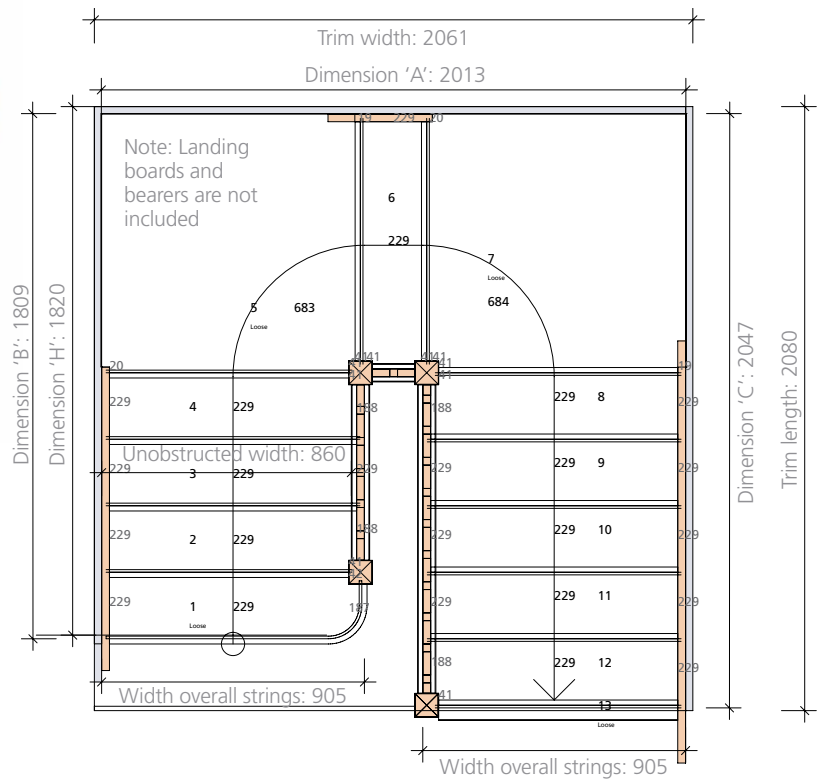

Layout E



Dimensions

- A: Wall string to wall string
 - B: Face of bottom riser to back of wall string
 - C: Back of top riser to wall string
 - H: Minimum distance to give statutory headroom
(Based on storey heights between 2588mm up to 2680mm with 339mm floor zone)
- Headroom based on storey heights between 2588mm up to 2680mm with 339mm floor zone.
- Unobstructed width dimension does not allow for a wall handrail; should this be a requirement the projection of the handrail would need to be deducted.

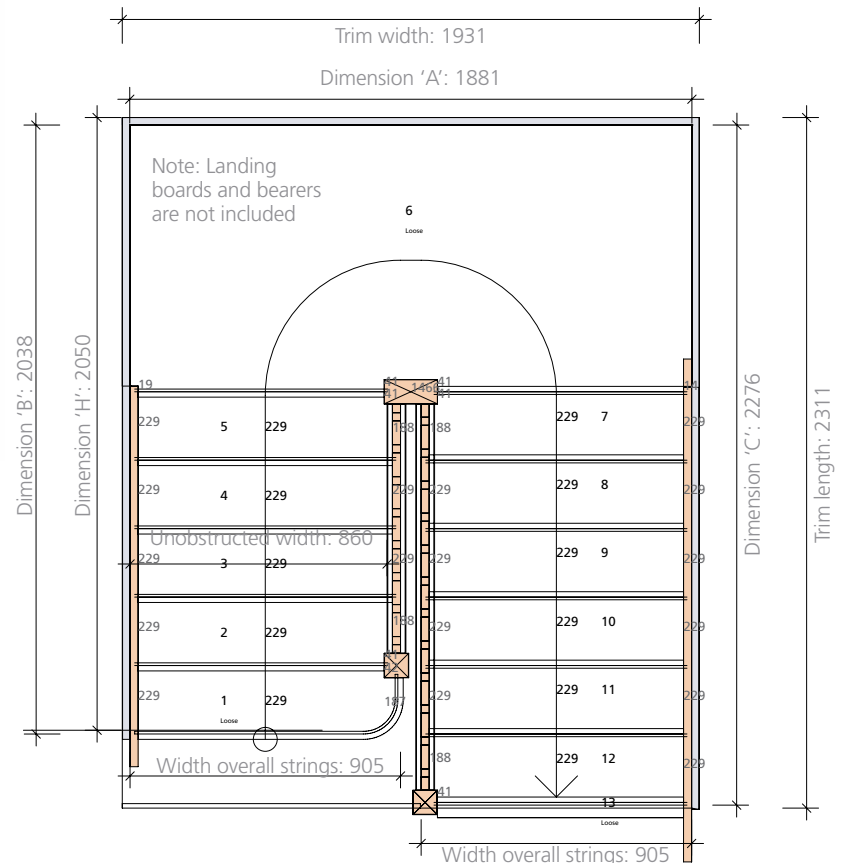

Layout F



Dimensions

A: Wall string to wall string

B: Face of bottom riser to back of wall string

C: Back of top riser to wall string

H: Minimum distance to give statutory headroom
(Based on storey heights between 2588mm up to 2680mm with 339mm floor zone)

Headroom based on storey heights between 2588mm up to 2680mm with 339mm floor zone.

Unobstructed width dimension does not allow for a wall handrail; should this be a requirement the projection of the handrail would need to be deducted.

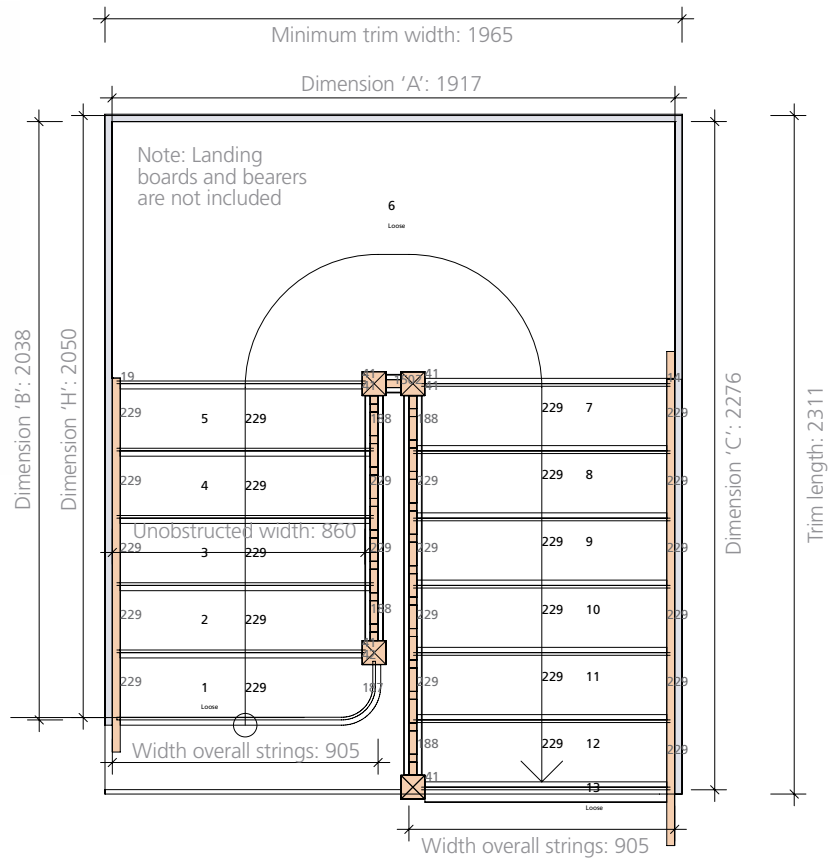

Layout G

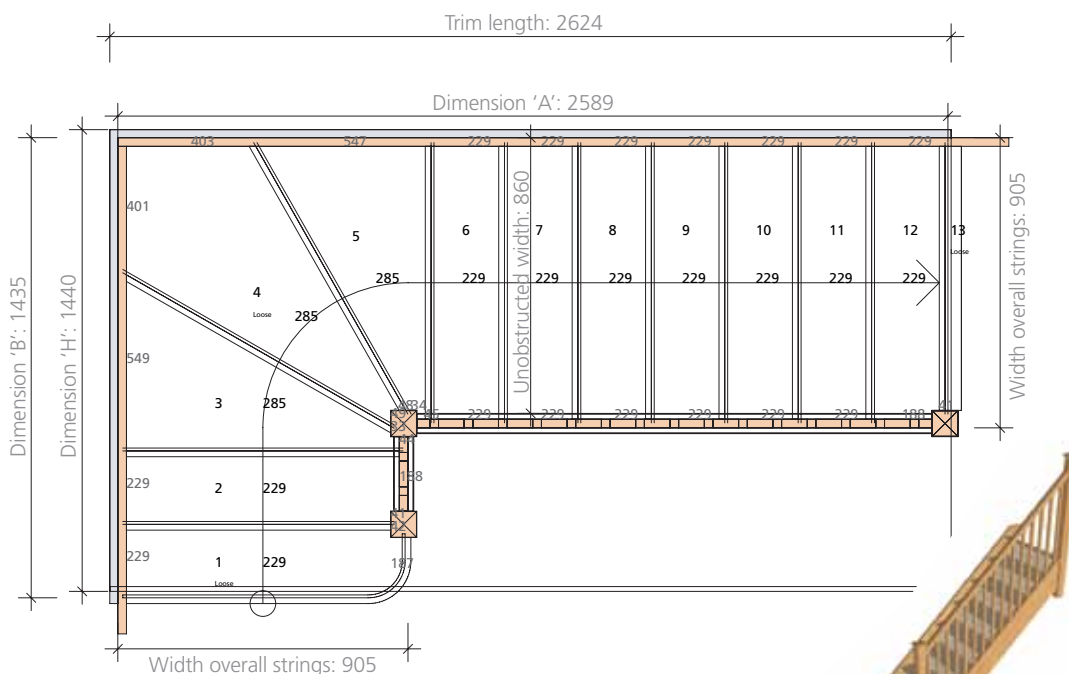

Dimensions

A: Wall string to back of top riser

B: Face of bottom riser to back of wall string

H: Minimum distance to give statutory headroom (Based on storey heights between 2588mm up to 2680mm with 339mm floor zone)

Headroom based on storey heights between 2588mm up to 2680mm with 339mm floor zone.

Unobstructed width dimension does not allow for a wall handrail; should this be a requirement the projection of the handrail would need to be deducted.



Layout H

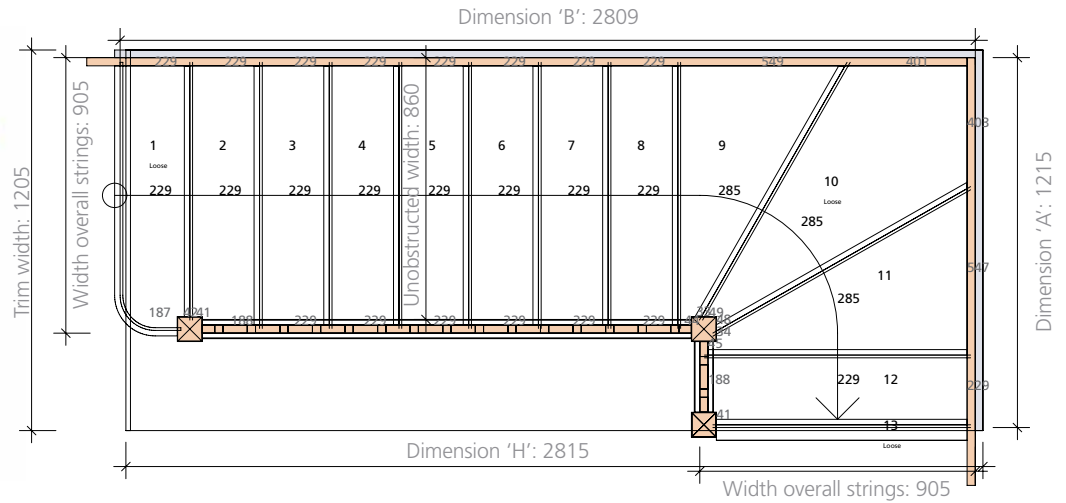

Dimensions

A: Wall string to back of top riser

B: Face of bottom riser to back of wall string

H: Minimum distance to give statutory headroom (Based on storey heights between 2588mm up to 2680mm with 339mm floor zone)

Headroom based on storey heights between 2588mm up to 2680mm with 339mm floor zone.

Unobstructed width dimension does not allow for a wall handrail; should this be a requirement the projection of the handrail would need to be deducted.

Layout I

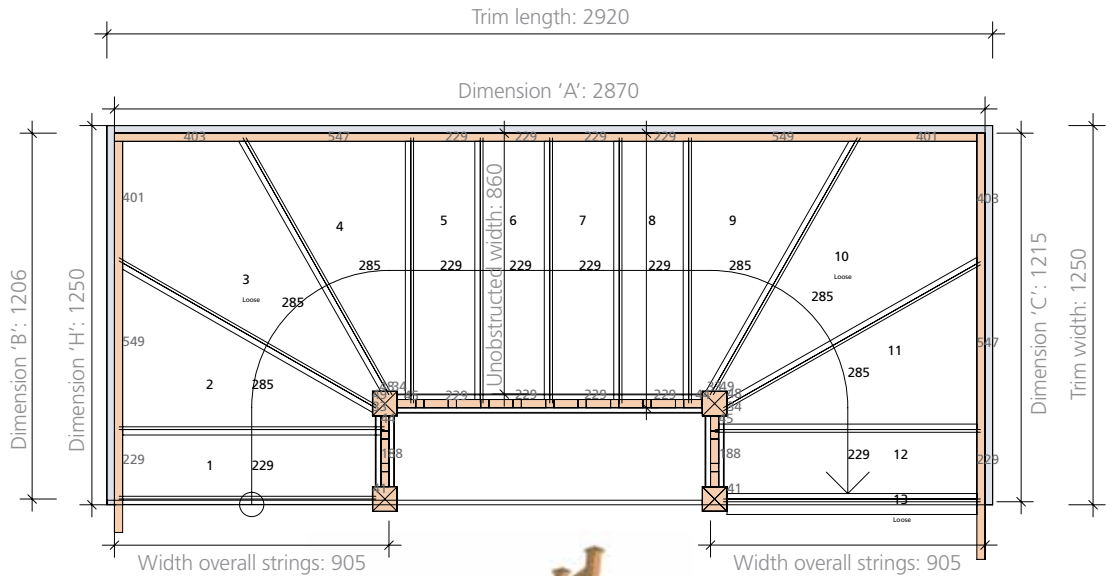

Dimensions

A: Wall string to wall string

B: Face of bottom riser to back of wall string

C: Back of top riser to wall string

H: Minimum distance to give statutory headroom (Based on storey heights between 2588mm up to 2680mm with 339mm floor zone)

Headroom based on storey heights between 2588mm up to 2680mm with 339mm floor zone.

Unobstructed width dimension does not allow for a wall handrail; should this be a requirement the projection of the handrail would need to be deducted.



Layout J



Dimensions

A: Wall string to wall string

B: Face of bottom riser to back of wall string

C: Back of top riser to wall string

H: Minimum distance to give statutory headroom
(Based on storey heights between 2588mm up to 2680mm with 339mm floor zone)

Headroom based on storey heights between 2588mm up to 2680mm with 339mm floor zone.

Unobstructed width dimension does not allow for a wall handrail; should this be a requirement the projection of the handrail would need to be deducted.

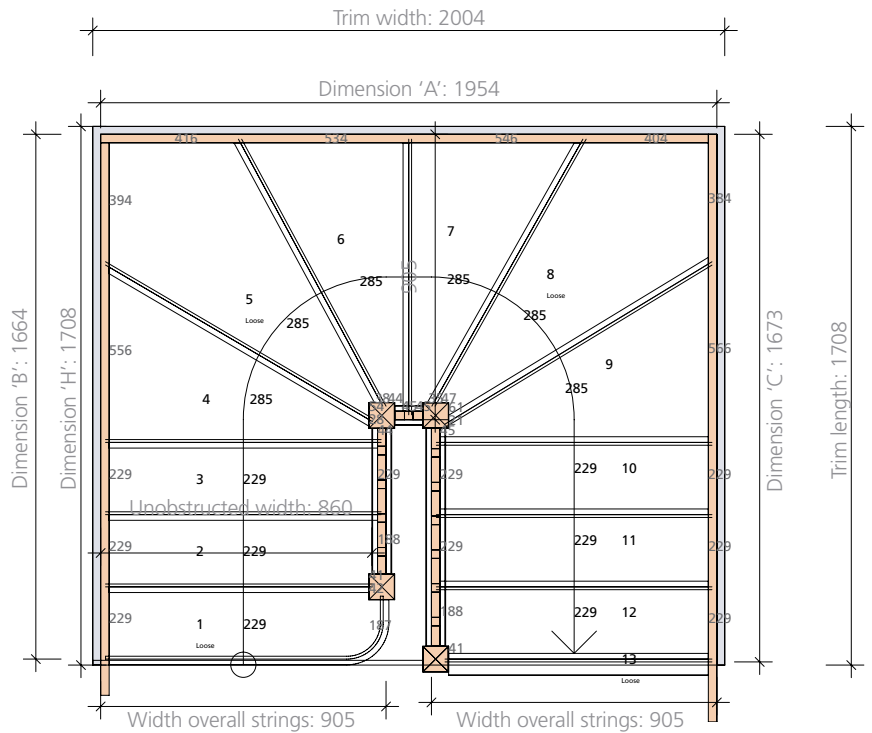

Layout K



Dimensions

A: Wall string to wall string

B: Face of bottom riser to back of wall string

C: Back of top riser to wall string

H: Minimum distance to give statutory headroom
(Based on storey heights between 2588mm up to 2680mm with 339mm floor zone)

Headroom based on storey heights between 2588mm up to 2680mm with 339mm floor zone.

Unobstructed width dimension does not allow for a wall handrail; should this be a requirement the projection of the handrail would need to be deducted.

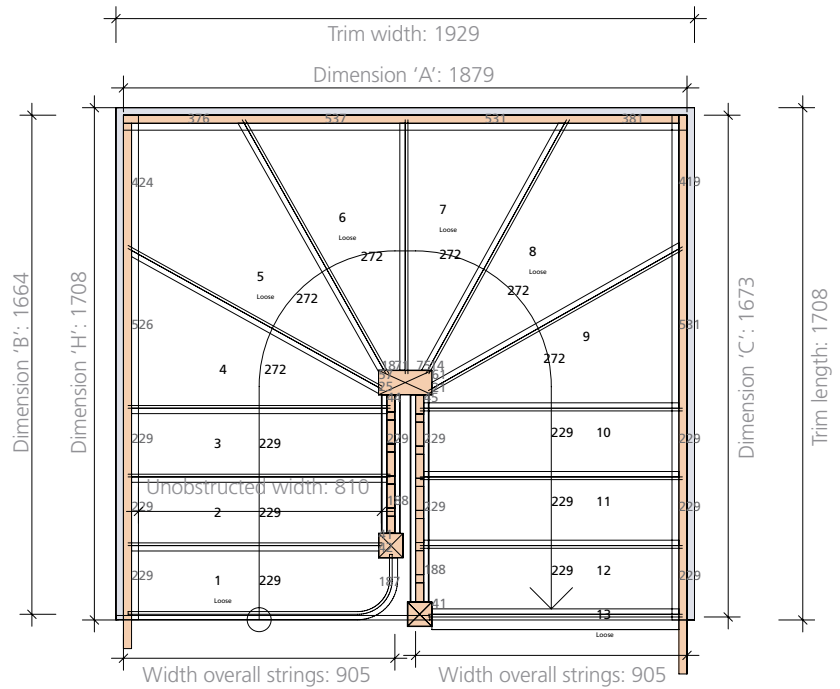

Layout L

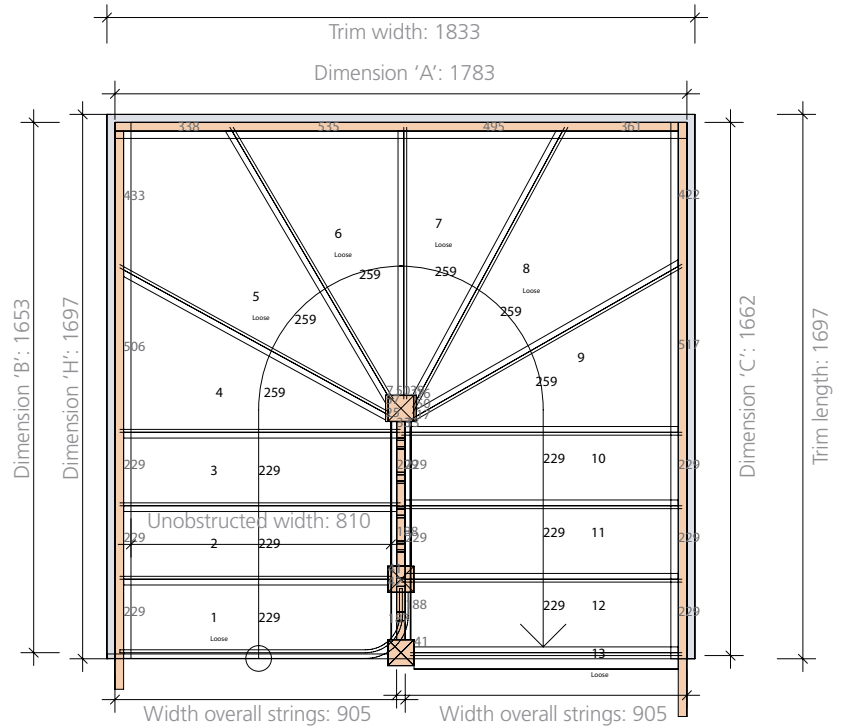

Dimensions

A: Wall string to wall string

B: Face of bottom riser to back of wall string

C: Back of top riser to wall string

H: Minimum distance to give statutory headroom (Based on storey heights between 2588mm up to 2680mm with 339mm floor zone)

Headroom based on storey heights between 2588mm up to 2680mm with 339mm floor zone.

Unobstructed width dimension based on a 'pigs ear' wall handrail with a 50mm projection being incorporated; should a different type be used the difference in projection would need to be taken into account.

Layout M

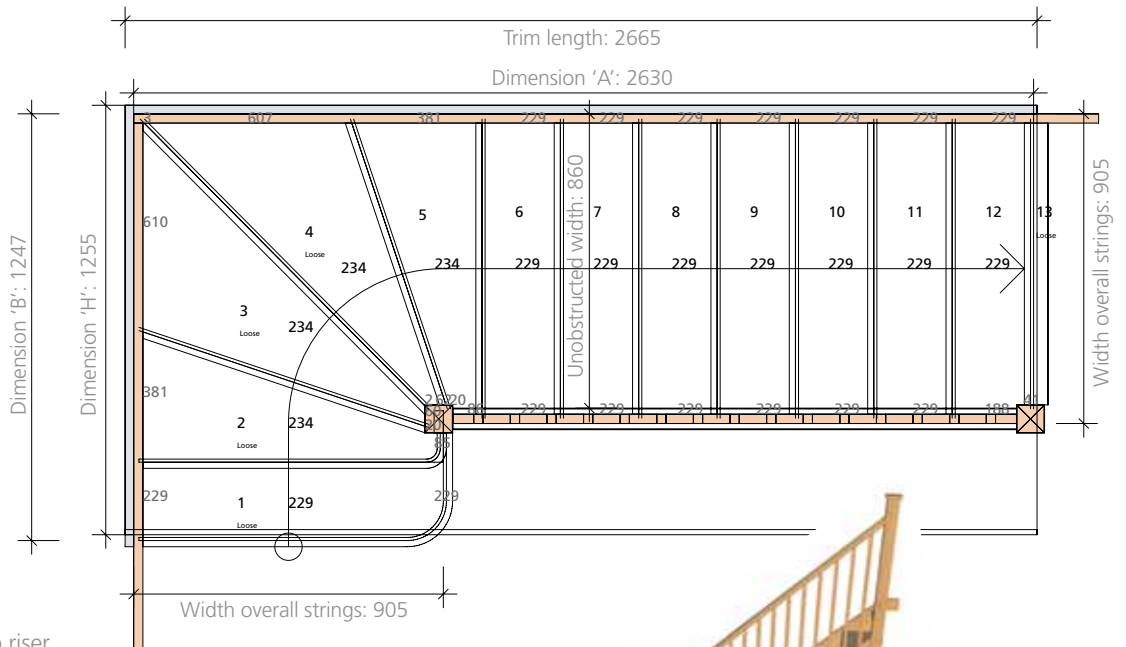

Dimensions

A: Wall string to back of top riser

B: Face of bottom riser to wall string

H: Minimum distance to give statutory headroom (Based on storey heights between 2588mm up to 2680mm with 339mm floor zone)

Headroom based on storey heights between 2588mm up to 2680mm with 339mm floor zone.

Unobstructed width dimension does not allow for a wall handrail; should this be a requirement the projection of the handrail would need to be deducted.



Layout N

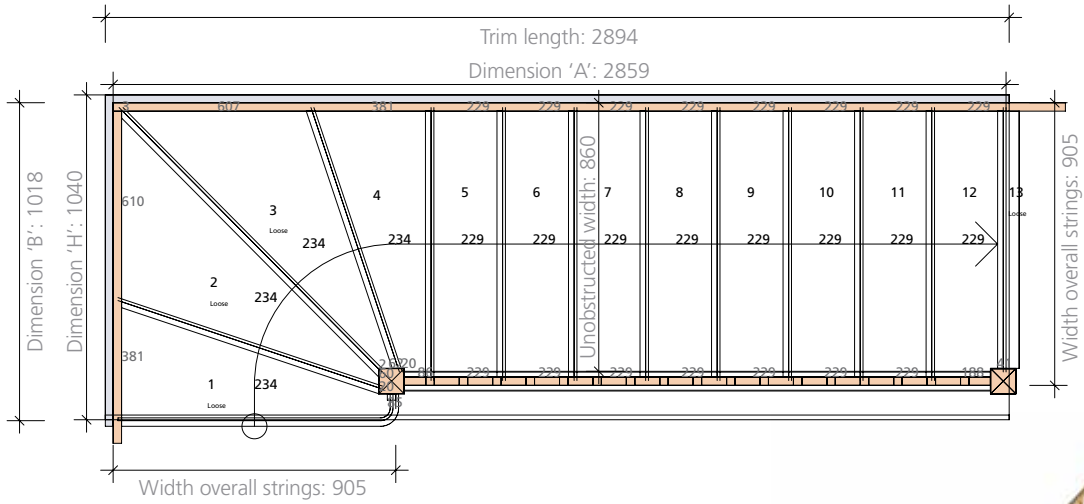

Dimensions

A: Wall string to back of top riser

B: Face of bottom riser to back of wall string

H: Minimum distance to give statutory headroom (Based on storey heights between 2588mm up to 2680mm with 339mm floor zone)

Headroom based on storey heights between 2588mm up to 2680mm with 339mm floor zone.

Unobstructed width dimension does not allow for a wall handrail; should this be a requirement the projection of the handrail would need to be deducted.



Layout O

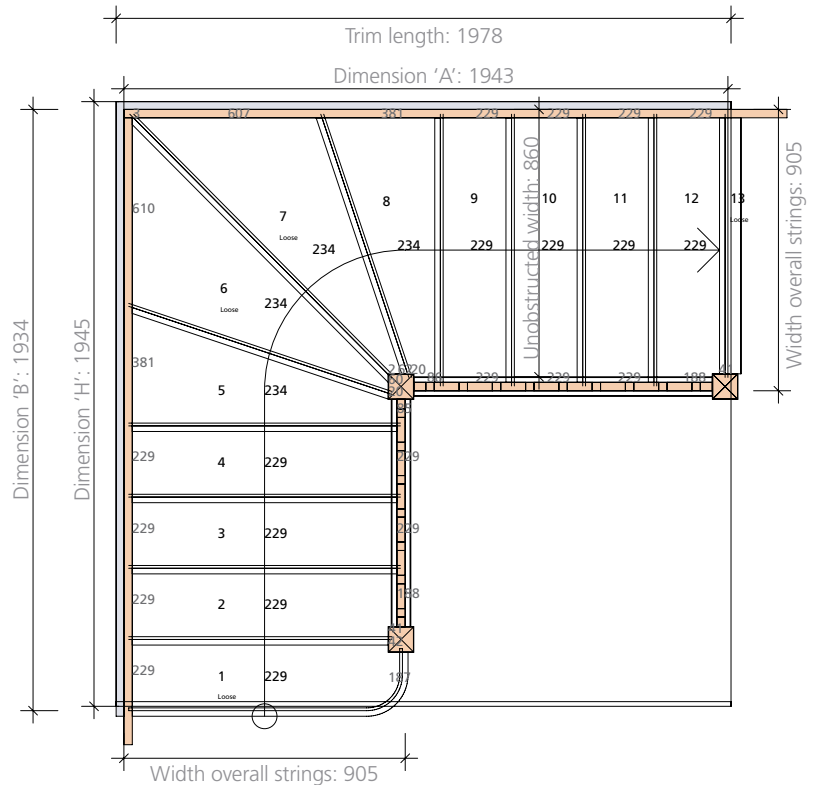

Dimensions

A: Wall string to back of top riser

B: Face of bottom riser to back of wall string

H: Minimum distance to give statutory headroom (Based on storey heights between 2588mm up to 2680mm with 339mm floor zone)

Headroom based on storey heights between 2588mm up to 2680mm with 339mm floor zone.

Unobstructed width dimension does not allow for a wall handrail; should this be a requirement the projection of the handrail would need to be deducted.

STAIR LAYOUTS

Layout P



Dimensions

- A: Wall string to wall string
- B: Face of bottom riser to back of wall string
- C: Back of top riser to wall string
- H: Minimum distance to give statutory headroom (Based on storey heights between 2588mm up to 2680mm with 339mm floor zone)

Headroom based on storey heights between 2588mm up to 2680mm with 339mm floor zone.

Unobstructed width dimension does not allow for a wall handrail; should this be a requirement the projection of the handrail would need to be deducted.

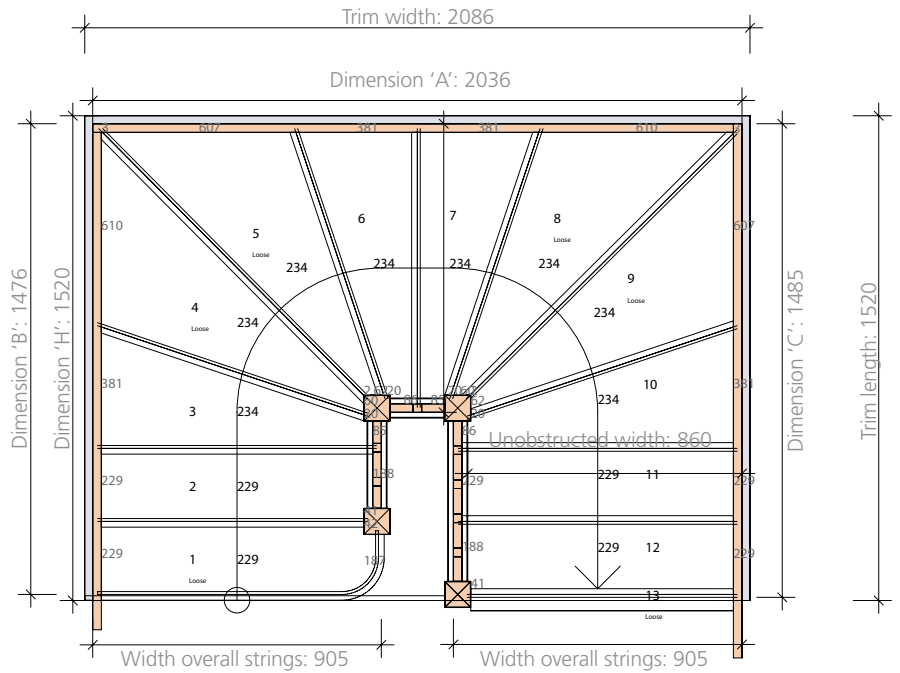

Layout Q



Dimensions

- A: Wall string to wall string
- B: Face of bottom riser to back of wall string
- C: Back of top riser to wall string
- H: Minimum distance to give statutory headroom (Based on storey heights between 2588mm up to 2680mm with 339mm floor zone)

Headroom based on storey heights between 2588mm up to 2680mm with 339mm floor zone.

Unobstructed width dimension does not allow for a wall handrail; should this be a requirement the projection of the handrail would need to be deducted.

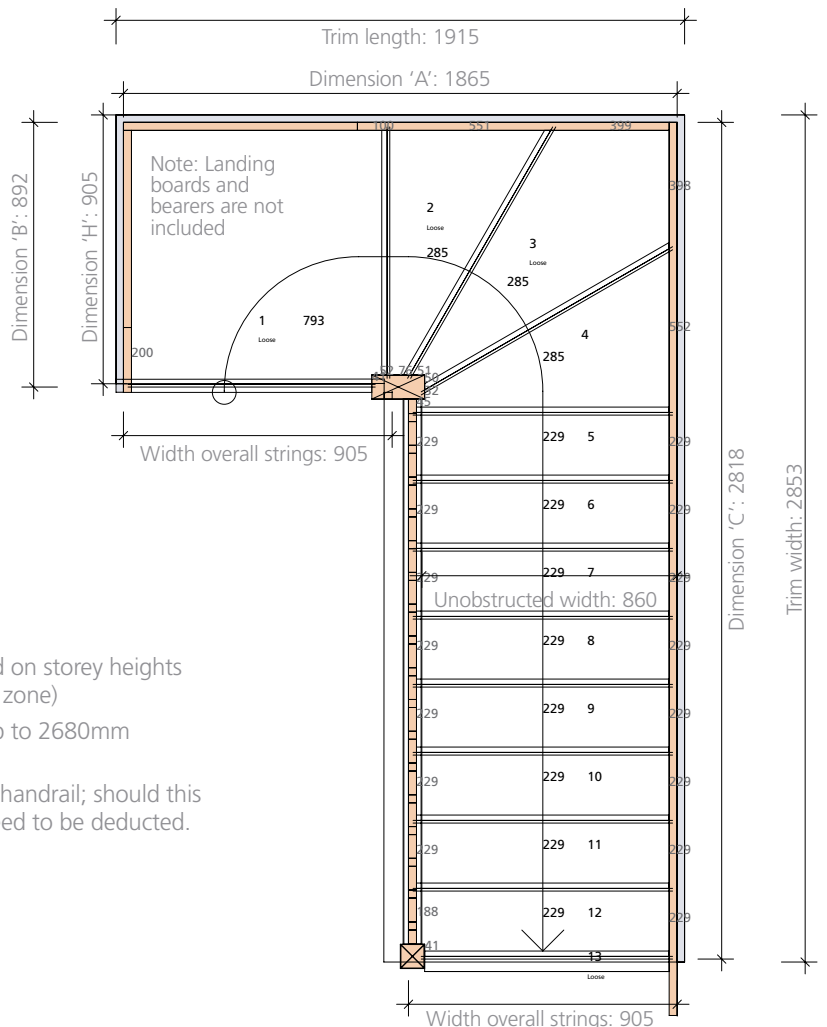

Layout R

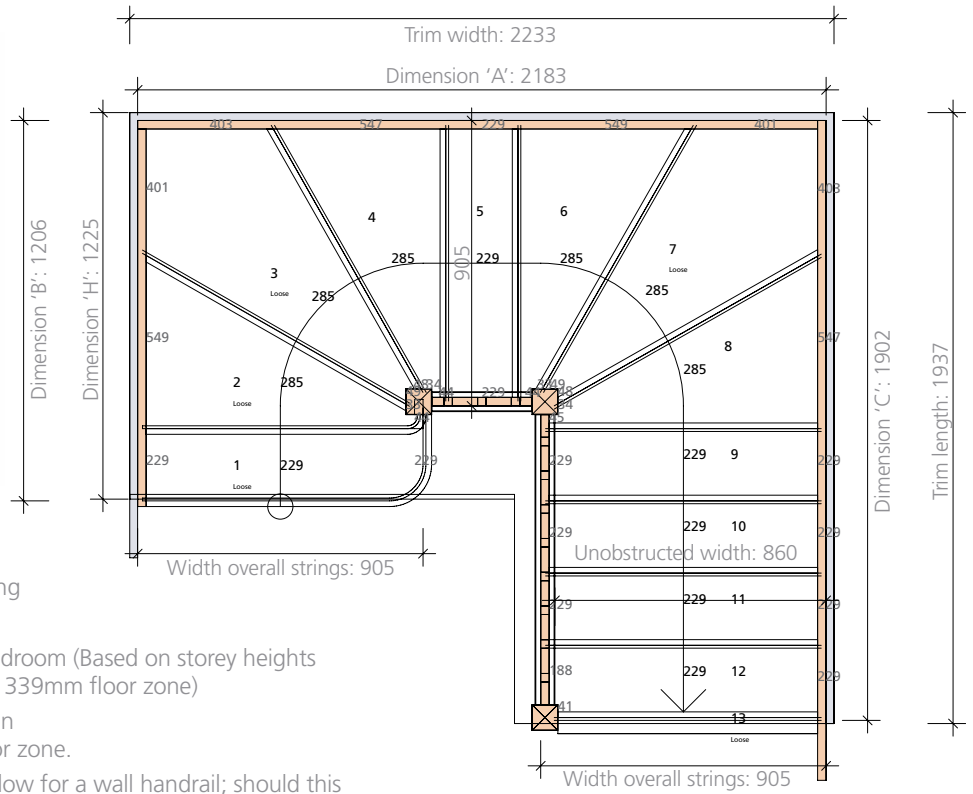

Dimensions

- A: Wall string to wall string
 - B: Face of bottom riser to back of wall string
 - C: Back of top riser to wall string
 - H: Minimum distance to give statutory headroom (Based on storey heights between 2588mm up to 2680mm with 339mm floor zone)
- Headroom based on storey heights between 2588mm up to 2680mm with 339mm floor zone.
- Unobstructed width dimension does not allow for a wall handrail; should this be a requirement the projection of the handrail would need to be deducted.

Layout S

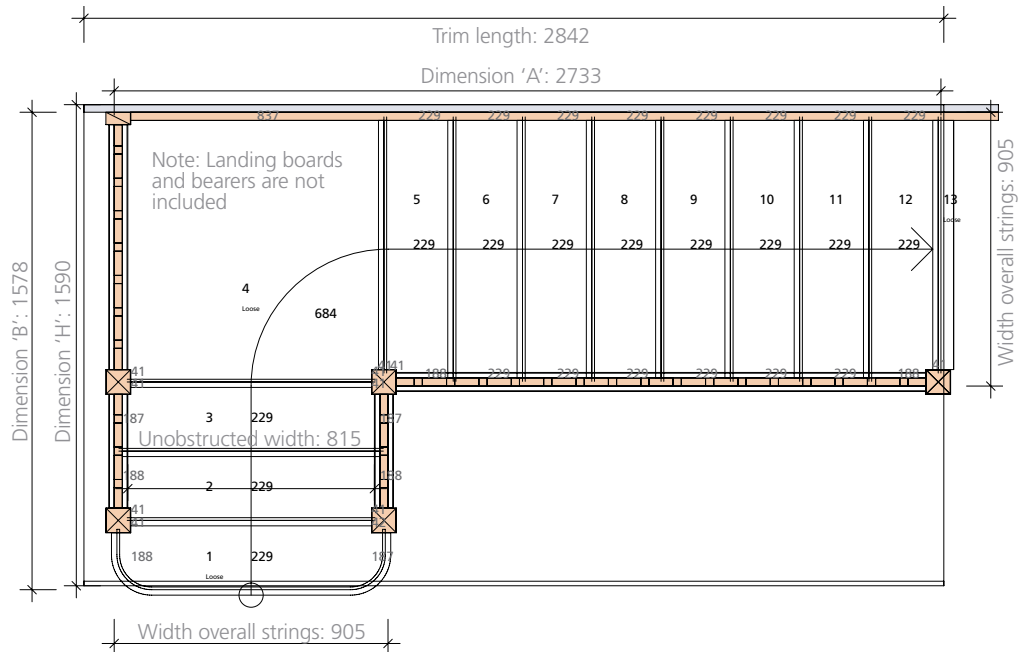

Dimensions

- A: Pulpit end string to back of top riser
 - B: Face of bottom riser to wall string
 - H: Minimum distance to give statutory headroom (Based on storey heights between 2588mm up to 2680mm with 339mm floor zone)
- Headroom based on storey heights between 2588mm up to 2680mm with 339mm floor zone.

STAIR LAYOUTS

Layout T

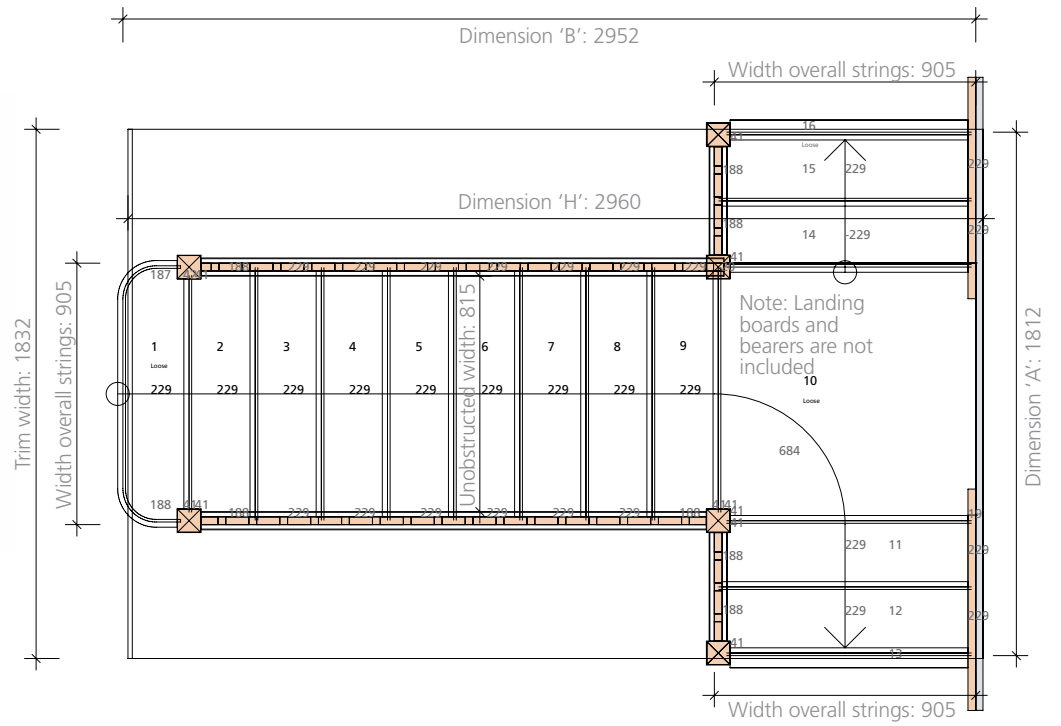

Dimensions

- A: Back of top riser to back of top riser
 - B: Face of bottom riser to back of wall string
 - H: Minimum distance to give statutory headroom (Based on storey heights between 2588mm up to 2680mm with 339mm floor zone)
- Headroom based on storey heights between 2588mm up to 2680mm with 339mm floor zone.