

# INSTALLATION GUIDE

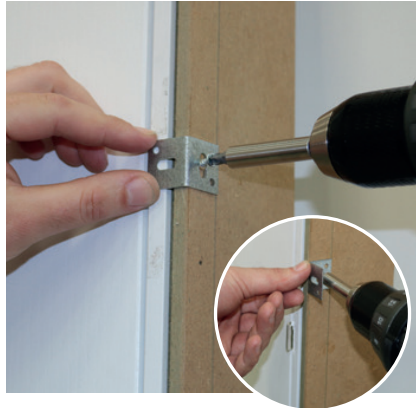

Doorsets are supplied plastic banded with a timber packing bar for distribution and ease of handling during fitting.



**STEP 1:** Unscrew all fixing brackets, reverse them and re-fit ready to offer the doorset to the opening.



**STEP 2:** Offer up the doorset into the opening, use packers on the edges of the doorset if required. To increase floor covering clearance, packers may be positioned under each jamb.



**STEP 3:** Screw the fixing brackets to the wall. Only screw them hand tight at this stage until step 4 is complete.



**STEP 4:** Using a spirit level, check the doorset is positioned square in the opening at all edges, pack where necessary.



**STEP 5:** Fully tighten the screws in the fixing brackets.



**STEP 6:** Now the doorset is in place, remove the plastic banding and the timber packing bar.



**STEP 7:** Unscrew and remove the metal transport bracket at the top of the doorset.



**STEP 8:** Using a spirit level, make sure the door and the frame is plumb and square.



**STEP 9:** Using the timber packing bar removed in step 6, position onto the frame and slide down from top to bottom checking for tightness or excessive gaps.





**STEP 10:** If you have excessive gaps you must add packers between the frame and the opening equally at either side.



**STEP 11:** Test the door closes into the frame correctly, ensuring that the door does not bind or catch in the frame.

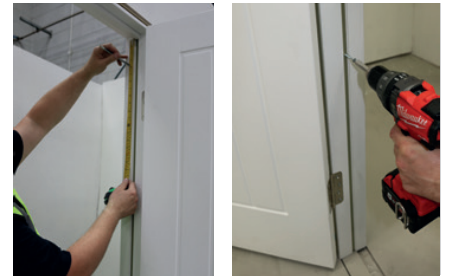

**STEP 12:** Using the fixing guide illustration, measure from the top and bottom, screw through the lining into the wall where machined for the door stops.



**STEP 13:** Removing the top stop and pins, use packers to adjust between the frame and the opening and fix in the centre. Using grab adhesive or pins refit the top stop.



**STEP 14:** Fix the two vertical door stops in position, using an appropriate grab adhesive and pins.



**STEP 15:** Take two pieces of the architrave, (one edge and the top piece) and offer them together.



**STEP 16:** Using the Hoffmann Key provided assemble both pieces of the architrave together.



**STEP 17:** Apply an appropriate grab adhesive to the groove in the lining that the architrave will be positioned in.



**STEP 18:** Press the two pieces of architrave in place, making sure that all areas are clicked into position and the corner joint is a tight fit.

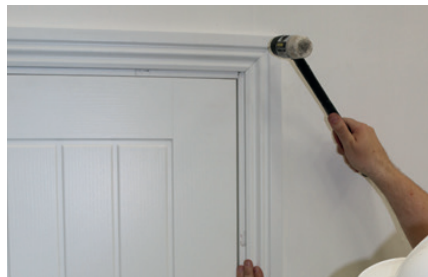

**STEP 19:** Add the final vertical piece of architrave, using a soft mallet if required. Making sure the architrave is level. Final fix using pins.

Repeat steps 15 to 18 on the reverse side of the door.

#### FIXING GUIDE



← = Fixing points through the door stop groove in the lining.

Note: Fire doorsets require additional fixings, please refer to the BWF certifiere label.