

READYFIT™ INSTALLATION GUIDE

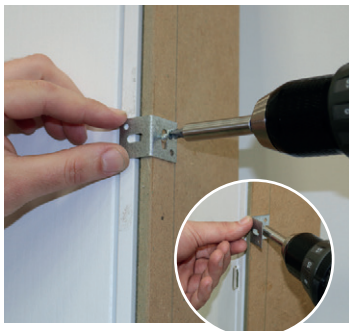

Doorsets are supplied plastic banded with a timber packing bar for distribution and ease of handling during fitting.



STEP 1: Unscrew all fixing brackets, reverse them and re-fit ready to offer the doorset to the opening.



STEP 2: Offer up the doorset into the opening, use packers on the edges of the doorset if required. To increase floor covering clearance, packers may be positioned under each jamb.



STEP 3: Screw the fixing brackets to the wall. Only screw them hand tight at this stage until step 4 is complete.



STEP 4: Using a spirit level, check the doorset is positioned square in the opening at all edges, pack where necessary.



STEP 5: Fully tighten the screws in the fixing brackets.

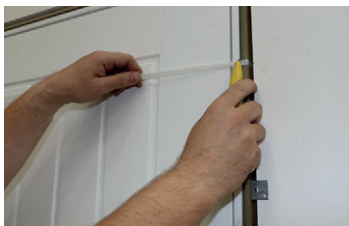

STEP 6: Now the doorset is in place, remove the plastic banding and the timber packing bar.



STEP 7: Unscrew and remove the metal transport bracket at the top of the doorset.



STEP 8: Using a spirit level, make sure the door and the frame is plumb and square.



STEP 9: Using the timber packing bar removed in step 6, position onto the frame and slide down from top to bottom checking for tightness or excessive gaps.



STEP 10: If you have excessive gaps you must add packers between the frame and the opening equally at either side.



STEP 11: Test the door closes into the frame correctly, ensuring that the door does not bind or catch in the frame.

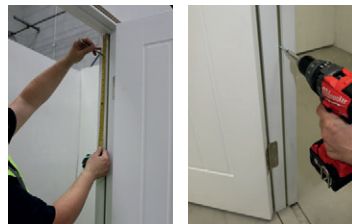

STEP 12: Using the fixing guide illustration, measure from the top and bottom, screw through the lining into the wall where machined for the door stops.



STEP 13: Removing the top stop and pins, use packers to adjust between the frame and the opening and fix in the centre. Using grab adhesive or pins refit the top stop.



STEP 14: Fix the two vertical door stops in position, using an appropriate grab adhesive and pins.



STEP 15: Take two pieces of the architrave, (one edge and the top piece) and offer them together.



STEP 16: Using the Hoffmann Key provided assemble both pieces of the architrave together.

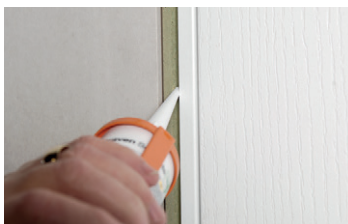

STEP 17: Apply an appropriate grab adhesive to the groove in the lining that the architrave will be positioned in.



STEP 18: Press the two pieces of architrave in place, making sure that all areas are clicked into position and the corner joint is a tight fit.

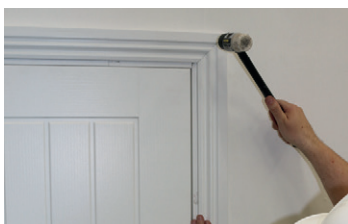

STEP 19: Add the final vertical piece of architrave, using a soft mallet if required. Making sure the architrave is level. Final fix using pins.

Repeat steps 15 to 18 on the reverse side of the door.

FIXING GUIDE



← = Fixing points through the door stop groove in the lining.