

**CF160  
FD30  
Fire Door**

**Storage**  
Store doors in dry conditions on 3 equally spaced lever bearers.

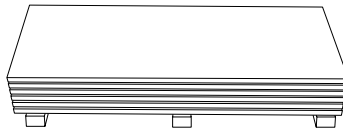

**JELD-WEN**

**Installation**

- Do not install in buildings immediately after plastering or other wet trades. To ensure good, door performance, particularly in new build situations.

**1** Keep doors half open.

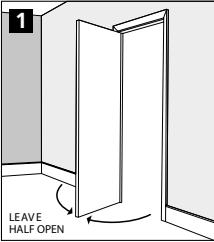

**2** Open trickle vents and set window sash on

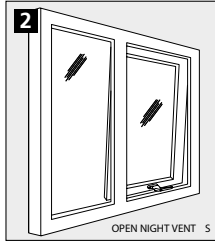

night vent position 24 hours a day. This will ensure a constant flow of dry air from outside, taking away any damp air from inside the property.

**3** We do not recommend the use of gas fired heaters in new build situations due to the release of carbon dioxide & water vapour adding further moisture to the air.

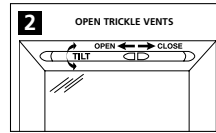

**Door configurations and sizes**

**Allowed**

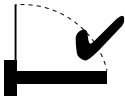

Max door size 2040mm x 926mm  
Single leaf, single acting



\*Please refer to CF160 data sheet for further details  
Double leaf, single acting

**Not allowed**

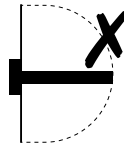

Single leaf, double acting

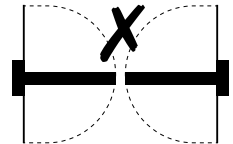

Double leaf, double acting

**Glazing & Air transfer grilles**

Glazing and cutting apertures for air transfer grilles may ONLY be carried out by Prime Door Manufacturers or BWF-Certifire Licensed Processors.

**Both leaves of pairs must be similarly glazed**



**IMPORTANT**

This door should always be fitted in conjunction with the correct technical data sheet available at [www.jeld-wen.co.uk](http://www.jeld-wen.co.uk) or phone **0845 122 2891**



**CF 160 A12345  
JELD-WEN UK Ltd  
Tel: 0845 122 2890**

Fire Door Certification invalid unless installed and maintained exactly in accordance with Manufacturer's instructions and this label is retained unmarked and not removed.



**FD  
30**

**NEVER REMOVE THIS TAMPER EVIDENT LABEL FROM THE TOP EDGE OF THE DOOR LEAF**

# Installation Instructions

All Dimensions are in Millimetres (mm)

## 1. Door Frame

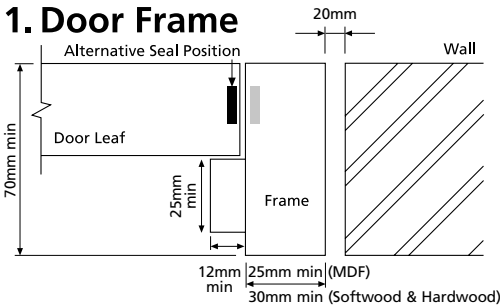

The frame to wall gap must be filled with stone wool or sealed with intumescent mastic if less than 6mm wide.

**Allowed door frame materials;** \*For species detail please refer to the technical data sheet.  
Softwood or hardwood\* 440kg/m<sup>3</sup>,  
MDF 720kg/m<sup>3</sup> minimum.

## 4. Door Seals

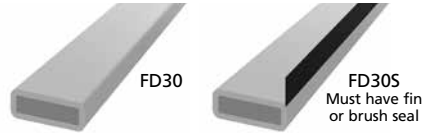

**For single acting, single leaf** – Certifire approved 15mm x 4mm intumescent fitted to the centre of the frame reveal in the head and both jambs, or fitted central to the door leafs thickness at the head and vertical edges.

**\*For single acting, double leaf** – Please refer to Section 9 in the CF160 data sheet for further information.

## 2. Hinge Position & Fixing Locations

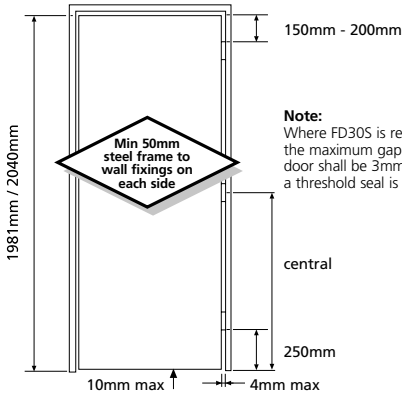

**Note:**  
Where FD30S is required the maximum gap under door shall be 3mm unless a threshold seal is fitted.

Measure from the top of the floor covering to the underside of the door.

## 5. Hinges & Screws

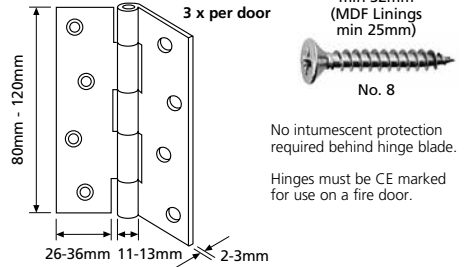

No intumescent protection required behind hinge blade.

Hinges must be CE marked for use on a fire door.

## 6. Lock or Latch

All dimensions are maximum

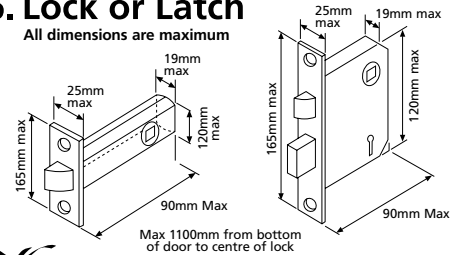

*certifire* Any Certifire approved lock or latch, must be CE marked.

## 3. Trimming of the door

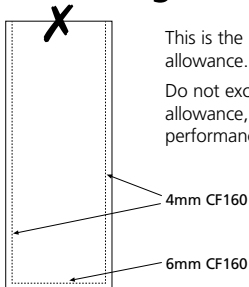

This is the maximum trim allowance.

Do not exceed recommended allowance, this will affect fire performance.

## 7. Door Closers

A door close is not be required for latched doorsets, used within single family occupancy dwellings.

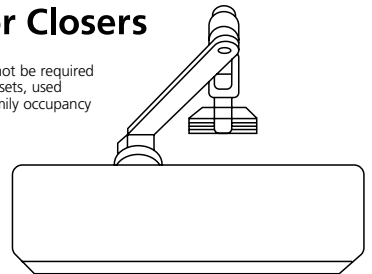

*certifire* Any Certifire approved closer to BS EN 1154, may be fitted subject to restrictions on use outlined the Certifire approval for the closer.